



Series 30000

# Long Hose Lengths Series 30000

## DIMENSIONS AND SPECIFICATIONS

		HOSE I.D.	1/4"	3/8"	1/2"	3/4"	1"
			(6.35mm)	(9.53mm)	(12.70mm)	(19.05mm)	(25.40mm)
		HOSE O.D.	.530"	.688"	.854"	1.188"	1.380"
			(13.4mm)	(17.5mm)	(21.5mm)	(30.2mm)	(35.0mm)
"B" WIDTH	WEIGHT	HOSE CAPACITY					
6"	38 lb	200'	140'	100'	50'		N/A
(152 mm)	(18 kg)	(61 m)	(43 m)	(30 m)	(15 m)		
12"	46 lb	425'	300'	200'	100'		N/A
(305 mm)	(21 kg)	(130 m)	(91 m)	(61 m)	(30 m)		
18"	54 lb	625'	450'	325'	175'	100'	
(457 mm)	(24 kg)	(191 m)	(137 m)	(99 m)	(54 m)	(31 m)	
22"	58 lb	780'	550'	400'	225'	125'	
(559 mm)	(27 kg)	(238 m)	(168 m)	(122 m)	(69 m)	(38 m)	
27"	66 lb	1000'	700'	500'	275'	150'	
(686 mm)	(30 kg)	(305 m)	(213 m)	(152 m)	(84 m)	(46 m)	

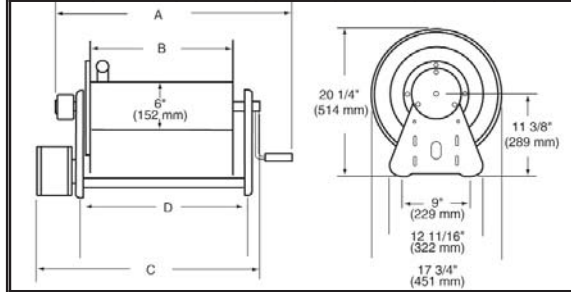

**Note:** Weights listed are for crank driven - Add for power driven, electric - all explosion proof 45 lb. (20.41 kg); 12 Volt D.C. 1/3 H.P. 30 lb. (13.61 kg); Air 6 AM 36 lb. (16.33 kg). \* Note: capacity chart is reference only.

For all metric thread connections over 1/2" add the suffix number 70 to indicate BSPT threads - example CA33112 M70.

Made in USA

## Heavy Duty Hand Crank and Motor Driven Reels

Air/Water/Oil - 1/4", 1/2", 3/4", 1" I.D.

Reelcraft's Series 30000 reels are designed for rugged, heavy duty applications requiring long lengths of hose and large storage capacity. All-bolted unitized construction with no welds to fatigue, full flow swivel and heavy gauge steel frame, spool and drum ensure longest service life. Series 30000's vibration-proof, self-locking fasteners are ideal for industrial or field use such as turf care or pest control.

Hand Crank  
CA33112L



**Hose Installation:** The Series 30000 gooseneck is easily removed from the reel for hose attachment. Simply remove the four fasteners attaching gooseneck to reel, connect hose to the gooseneck and re-connect to the reel. NOTE: Do not discard the O-ring; insure that the O-ring is properly fitted into the grooves when replacing the gooseneck.

## Model Number Significance

EA 3 2 1 12 L 12 D X

### Drive Type

- AA - Air, Pneumatic motor driven
- BA - Bevel crank - Front position
- CA - Hand crank direct drive
- EA - Electric driven, AC or DC
- HA - Hydraulic driven

### Swivel Size

- 0 - No Swivel
- 2 - 1/2" (13mm) I.D.
- 3 - 3/4" (19mm) I.D.
- 4 - 1/2" (13mm) Dual
- 5 - 3/4" (19mm) Dual
- 6 - 1/4" (6mm) Dual
- 7 - 1" (25mm) I.D.
- 8 - 1/2" (13mm) I.D. Pressure Wash

### Explosion Proof X

### Electric Current Type

Electric Motor only

### Power Source

A - A.C.  
D - D.C.

### Pressure Type

- 12 - 12 Volt D.C.
- 24 - 24 Volt D.C.
- 10 - 115 Volt A.C.
- 4A - 1 1/2 hp (Air Motor)
- 6A - 4 hp (Air Motor)

### Width of Spool

- L - 1000 PSI (69 bar)
- M - 3000 PSI (207 bar)

### NOTE:

This chart is for reference purposes only. Reels cannot be ordered by selecting from this chart. Please see selection charts or consult manufacturer for additional models not listed in selection chart or for any questions about option combinations.

- 06 - 6" (152mm) Width of spool
  - 12 - 12" (305mm) Width of spool
  - 18 - 18" (457mm) Width of spool
  - 22 - 22" (559mm) Width of spool
  - 28 - 27" (686 mm) Width of spool
- Refer to line drawing above

**CAUTION:** To prevent drum damage, fully extend and pressurize hose, then wind on the reel. The 30000 series should always be wound under pressure.



Wind Things Up With Reelcraft™