

## Premium Duty Spring Retractable Reels Air/Water/Oil/Grease - 1/4", 3/8", 1/2" I.D.

Series 4000, 5000 and 5005 reels are all-steel construction and compact for a wide range of applications with critical space requirements. A full flow shaft and swivel assures maximum product delivery. Guide arm adjusts to two positions.



4625 OLP

5635 OLP

5650 OLP



Enclosed Model

5435 ELP

Made  
in USA

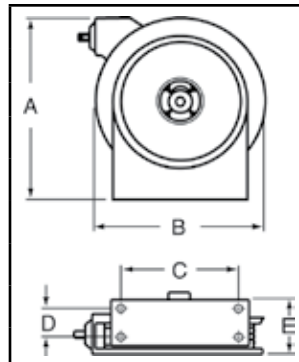

Dimensions - Size Index						
No.	1	2	3	4		
	in / mm		in / mm		in / mm	
<b>A</b>	12 <sup>7</sup> / <sub>8</sub>	327	14 <sup>1</sup> / <sub>2</sub>	368	17 <sup>1</sup> / <sub>2</sub>	445
<b>B</b>	12 <sup>5</sup> / <sub>8</sub>	321	13 <sup>1</sup> / <sub>2</sub>	343	16 <sup>1</sup> / <sub>2</sub>	419
<b>C</b>	8	203	9 <sup>3</sup> / <sub>4</sub>	248	9 <sup>3</sup> / <sub>4</sub>	248
<b>D</b>	2 <sup>1</sup> / <sub>2</sub>	64	2 <sup>1</sup> / <sub>2</sub>	64	2 <sup>1</sup> / <sub>2</sub>	64
<b>E</b>	5 <sup>3</sup> / <sub>8</sub>	137	6	152	6	152

Four 5/16" (8mm) diameter mounting holes.

**NOTE:** See operating instructions for optimum mounting configuration.

**Enclosed Models:** Series 5000 E reels are the same as 5000 O reels except E Series reels are fully enclosed. To order, change the model number suffix letter O to E, Example: 5430 OHP becomes 5430 EHP. Add 8 lbs. to open reel weight. Enclosed version is only available for Series 5000 reels (size index 2 reels). Refer to reelcraft.com for dimensional information.

Quiet latch with Hose	Ratchet latch with Hose	Shipping Weight	Pressure	Hose I.D.	Hose O.D.	(M)NPTF Outlet	(F)NPTF Inlet	Hose Length	Quiet latch without hose & bumper	Shipping Weight	Pressure	Size Index #
		lbs / kg	psi / bar	in / mm	in / mm	in	in	ft / m		lbs / kg	psi / bar	
<b>Low Pressure Air/Water Reels</b> Maximum Temperature 150° F (65° C)												
4420 OLP	-----	18 8	300 21	1/4 6	.475 12	1/4	3/8	20 6	4400 OLP	17 8	500 35	1
4425 OLP	B4425 OLP	19 9	300 21	1/4 6	.475 12	1/4	3/8	25 8	4400 OLP	17 8	500 35	1
4435 OLP	B4435 OLP	19 9	300 21	1/4 6	.475 12	1/4	3/8	35 11	4400 OLP	17 8	500 35	1
5450 OLP	B5450 OLP	26 12	300 21	1/4 6	.475 12	1/4	3/8	50 15	5400 OLP	20 9	500 35	2
4617 OLP	-----	19 9	300 21	3/8 10	.600 15	1/4	3/8	17 5	4600 OLP	17 8	500 35	1
4625 OLP	B4625 OLP	20 9	300 21	3/8 10	.600 15	1/4	3/8	25 8	4600 OLP	17 8	500 35	1
5635 OLP	B5635 OLP	25 11	300 21	3/8 10	.600 15	1/4	3/8	35 11	5600 OLP	21 10	500 35	2
5650 OLP	B5650 OLP	36 16	300 21	3/8 10	.600 15	1/4	3/8	50 15	5605 OLP	31 14	500 35	3
A5825 OLP	B5825 OLP	27 12	300 21	1/2 13	.750 19	1/2	3/8	25 8	A5800 OLP	22 10	500 35	2
A5835 OLP	B5835 OLP	39 18	300 21	1/2 13	.750 19	1/2	3/8	35 11	A5805 OLP	32 15	500 35	3
A5850 OLP	B5850 OLP	41 19	300 21	1/2 13	.750 19	1/2	3/8	50 15	A5806 OLP	35 16	500 35	4
<b>Medium Pressure Oil Reels</b> Maximum Temperature 210° F (99° C)												
5435 OMP	B5435 OMP	31 14	2750 190	1/4 6	.530 13	1/4	3/8	35 11	5400 OMP	23 10	3000 207	2
5630 OMP	B5630 OMP	31 14	2250 155	3/8 10	.710 18	3/8	3/8	30 9	5600 OMP	24 11	3000 207	2
A5825 OMP*	B5825 OMP*	34 15	2000 138	1/2 13	.850 22	1/2	3/8	25 8	A5800 OMP	24 11	3000 207	2
A5835 OMP	B5835 OMP	42 19	2000 138	1/2 13	.850 22	1/2	3/8	35 11	A5805 OMP	32 15	3000 207	3
<b>High Pressure Grease Reels</b> Maximum Temperature 210° F (99° C)												
5430 OHP	-----	30 14	5000 345	1/4 6	.580 15	1/4	1/4	30 9	5400 OHP	23 10	5000 345	2
5435 OHP	B5435 OHP	39 18	5000 345	1/4 6	.580 15	1/4	1/4	35 11	5405 OHP	33 15	5000 345	3
5625 OHP	B5625 OHP	32 15	4000 276	3/8 10	.730 19	1/4	1/4	25 8	5600 OHP	26 12	5000 345	2

Low pressure hose reels furnished standard with PVC hose. Compressed air hoses should not be converted to oxygen service - may cause explosion when O<sub>2</sub> mixes with fuel. Medium pressure reels furnished standard with S.A.E. 100 R1T one wire braid hose. \*Floor tank mount only - do not mount on ceiling. High pressure reels furnished standard with S.A.E. 100 R2T two wire braid hose.

<b>Available Options</b>	<b>Mounting Brackets</b> See page 47	<b>Inlet Hose Assemblies</b> See page 49	<b>Replacement Bumpers</b> See page 49	<b>Replacement Hoses</b> See page 50
--------------------------	---	---	---	---