

Operating Instructions

Series 7000 Spring Driven Hose Reels

Clean Air Hose Reel Model Number:

7800 OLB21



Dimensions

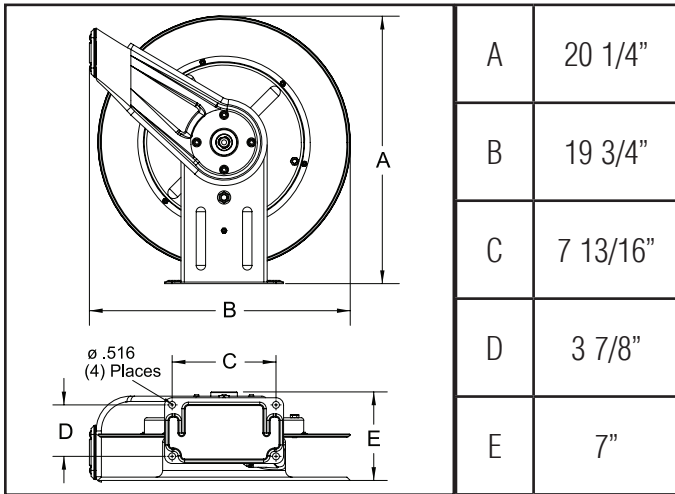

SAFETY

1. Do not use reel at higher pressures or temperatures than listed on the back of this bulletin.
2. Remove all spring tension before beginning disassembly process.

INSTALLATION:

A flexible hose connection must be used between the hose reel inlet and the source of supply to prevent possible misalignment and binding.

MOUNTING:

The hose reel is equipped with a universal mounting bracket so that it can be mounted on the floor, wall or ceiling; whichever place is convenient. The hose guide arm can be moved to the position desired by removing the nuts fastening the guide bracket to the reel base. Shift the guide arm bracket so the hose comes off the reel at the desired position and replace the nuts. A 180° wall mount bracket (600626) or 340° pivot base (600608) are also available consult manufacturer.

LUBRICATION:

Hose reel spring and bearings are factory lubricated and require no further lubrication.

REPLACING HOSE:

1. Wind spool flange clockwise-facing swivel-until spring is tight.
2. Back off three turns and latch.
3. Insert hose through roller guide.
4. Connect hose fitting to swivel joint and secure hose with clamps.

ADJUSTMENTS:

To adjust spring tension, add or remove wraps of hose from the spool, one wrap at a time until desired tension is obtained.

REPAIRS:

Extensive repairs should be performed only by an authorized serviceman or factory to avoid damage which may void your warranty. Remove all spring tension before beginning disassembly process.

Form# 951-698 Rev: 6/2019

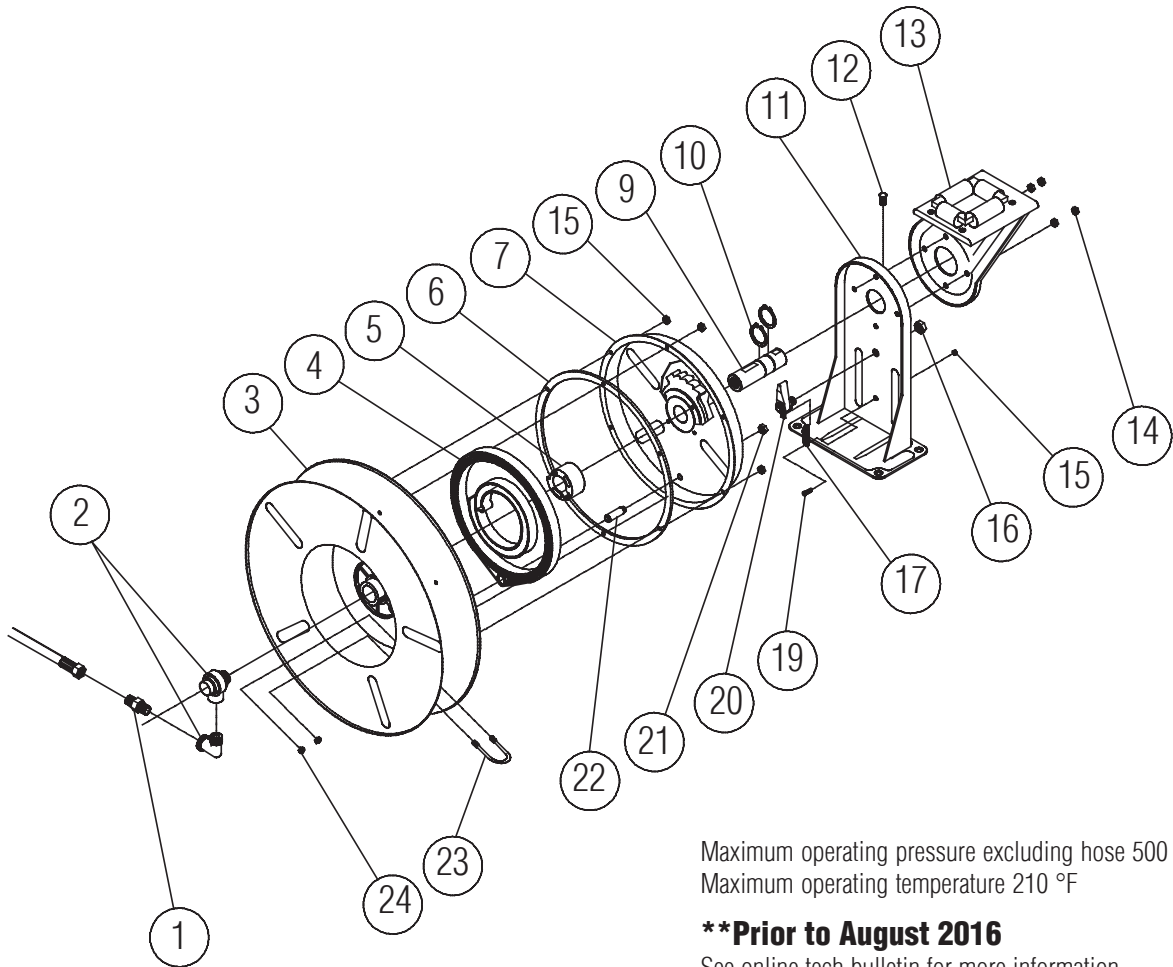

Maximum operating pressure excluding hose 500 PSI
 Maximum operating temperature 210 °F

****Prior to August 2016**
 See online tech bulletin for more information

Item #	Part #	# Req.	Description	Item #	Part #	# Req.	Description	Item #	Part #	# Req.	Description
1	261337	1	Adapter Union	9	261370	1	Main shaft**	16	S280-8	1	1/2-20 Hex Nut
2	600375-4B	1	Swivel Assembly**	9	S602683-B	1	Main shaft	17	S260067	1	Latch Spring
2	602691-4B	1	Swivel Assembly	10	300007	2	1 1/4" Snap Ring	19	S393-2	1	10-32 Shoulder Screw
3	S260011-40	1	Sheave Assembly	11	600016-40	1	Base Assembly	20	S600018	1	Latch Pawl Assembly
4	S260037	1	Drive Spring Assembly	12	S35-84	1	1/2-13 Set Screw	21	S76-106	1	3/8-24 Jam Nut
5	S600621	1	Spring Arbor Assembly	13	600017-40	1	Guide Arm w/rollers	22	S260031	1	Spring Case Stud
6	S260069	1	Gasket	14	300107	4	5/16-18 Lock Nut	23	3-117440	1	U-bolt
7	S260074-40	1	Spring Case Assembly	15	S82-15	7	10-32 x 3/8" Nyloc Nut	24	261650-1	2	1/4-20 x 3/8" Lock Nut

Installation Reference Drawing

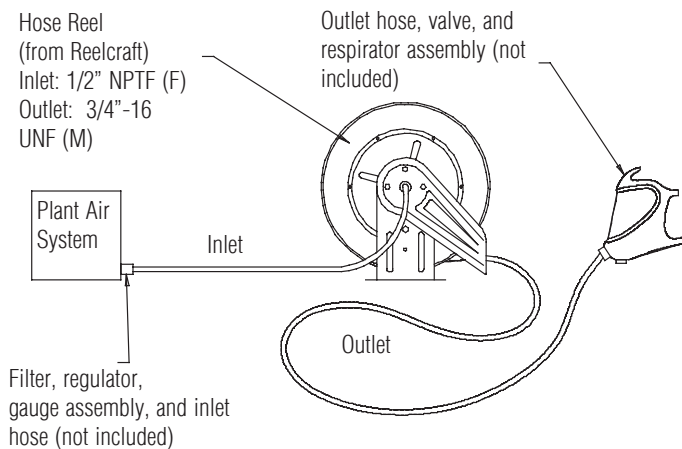

1. Clean air hose reels do not include filter, regulator, gauge, hose, valve or respirator.
2. Reel swivel union is 3/4-16 UNF male to fit MSA #455022 hose or equivalent. (1-800-MSA-2222)

WARNING: Only use hose supplied with mask. Substitution may result in injury or death.

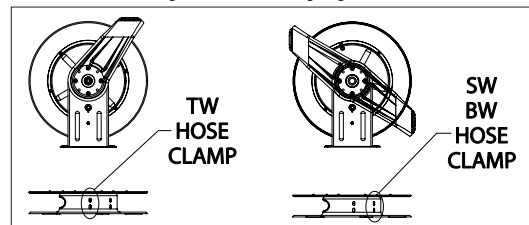

When changing guide arm positions, the U-bolt must be placed in the proper location as instructed above. The reel can "latch out" during use if this instruction is not adhered to.