

Tech Bulletin

Series RT Spool Improvement

In the spirit of continuous improvement, the need to upgrade the Series RT spool material was identified. The spool is now produced from a new engineered plastic proven to be highly durable in environments such as industrial usage and weather cycles. Due to the improvement, the physical reel width slightly increased for the following reel models (including side mount):

RT402-OLP	RT405-OLP	RT435-OLP	RT602-OLP	RT603-OMP	RT635-OLP
RT402-OHP	RT406-OLP	RT435-OHP	RT602-OMP	RT625-OLP	RT635-OMP
RT403-OLP	RT425-OLP	RT450-OLP	RT602-OHP	RT625-OMP	RT450-OLPSM
RT403-OHP	RT425-OHP	RT465-OLP	RT603-OLP	RT625-OHP	RT635-OLPSM

Dimensions

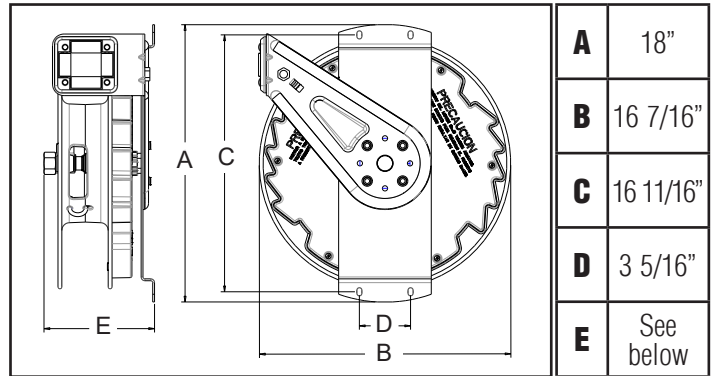
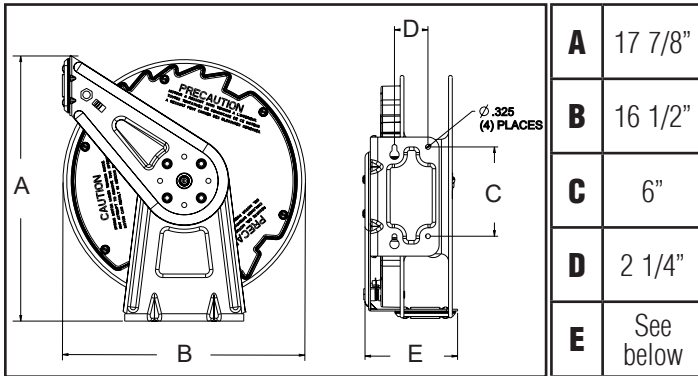

"E" Dimension:

Reels with date code **191025-004** or prior: 5 3/4"
 Reels with date code **191028-004** or after: 6 1/4"
 All other dimensions remain unchanged

"E" Dimension:

Reels with date code **191025-004** or prior: 6 1/8"
 Reels with date code **191028-004** or after: 7 5/16"
 All other dimensions remain unchanged

Identification:

If the date code is not available, for easy identification reference the spring case fasteners:

New RT spool
Fasteners



Previous RT spool
No Fasteners



Support:

For service parts and support for reels produced prior to date code 191028-004, please contact Technical Services 855-634-9109.

Form # TB0049 Rev: 4/2020